

**Non-Rotating Hanger**

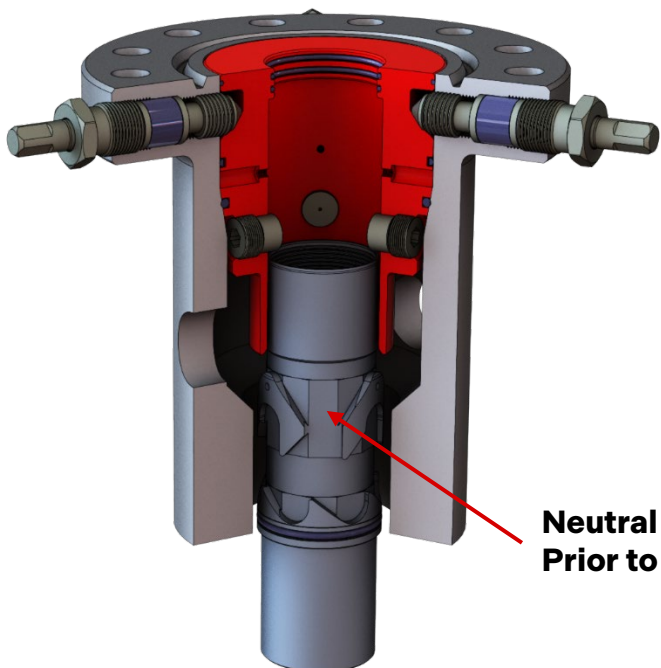

The Auto Latch Tubing Hanger is a rugged, field-friendly tubing hanger engineered for safe and reliable setting of downhole tools. Its patented automatic latching/unlatching works with a single up-and-down motion. No extra tools or hand operations required, which reduces rig time and operator exposure while improving run-in reliability.

## Features

- **Automatic Latching:** The hanger sets and releases with a simple up-and-down motion, eliminating the need for low-lying slips and reduces the risk of over-pulling.
- **Tubing Head Protection:** A protective seal at the top of the hanger is designed to protect the lockdown bolts from solids and corrosion.
- **Tool-Free Attachment:** No hand tools are required to attach the hanger shell to the mandrel, streamlining the process.
- **BPV Threads Option:** Available with BPV threads for enhanced tubular well control.
- **Compatibility:** Integrates seamlessly with our tubing rotator system.
-

**A-Style Auto Latch - Non-Rotating**

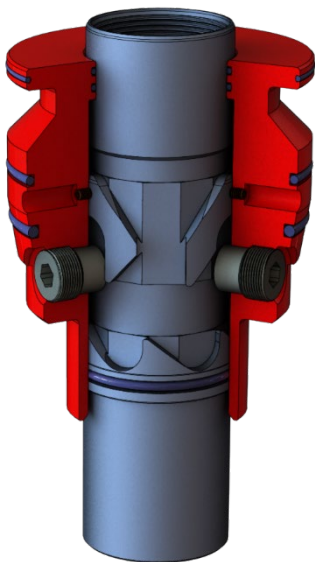

**TC1A Auto Latch - Non-Rotating**

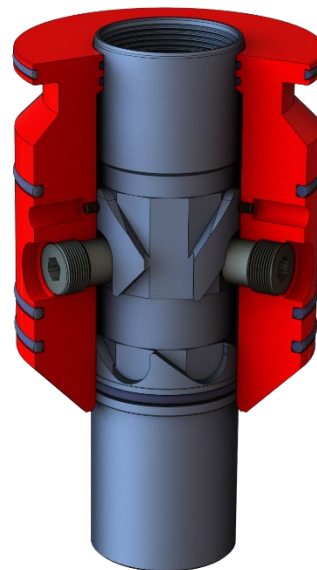

Specifications										
Casing			Auto Latch Tubing Hanger							
Size	Weight	Min. Drift Size	Mandrel Thread	Mandrel O.D.	A-Style Hanger Assembly Part #	CT-Style Hanger Assembly Part #	Mandrel Part #	Lower Thread	# of Pins	Max. Load Rating
in mm	lbs/ft kg/m	in mm	in mm	in mm						lbs kgs
4-1/2 114.3	9.5 - 15.1 14.1 - 22.5	3.701 94.0	2-3/8 EUE 60.3 EUE	3.695 93.9	205199	205263	205201	Box	3	80,000 36,287
5 127.0	11.5 - 18.0 17.1 - 27.8	4.151 105.4								
5-1/2 139.7	14.0 - 39.3 20.8 - 58.5	3.919 99.5								
4-1/2 114.3	9.5 - 13.5 14.1 - 20.1	3.795 96.4	2-7/8 EUE 73.0 EUE	3.747 95.2	205364	205385	205363	Box	3	80,000 36,287
5 127.0	11.5 - 18.0 17.1 - 27.8	4.151 105.4								
5-1/2 139.7	14.0 - 32.2 20.8 - 47.9	4.151 105.4								
7 177.8	All	All								
5-1/2 139.7	13.0 - 26.0 19.3 - 38.6	4.423 112.3		4.375 111.1	205407	205402	205404	Box	3	105,000 47,627
7 177.8	All	All								

**Note:** Adapter flanges available for unknown or unverifiable Tubing Head Profiles. NACE MRO-177 Compliant.