

Advanced Torque Anchor

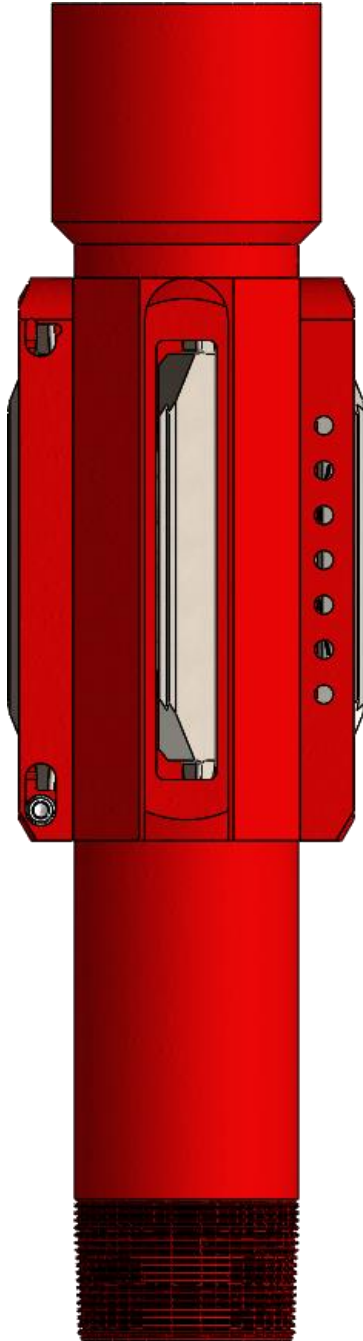

The **Evolution Advanced Torque Anchor (ATA)** is designed to transfer the PC Pump torque to the casing walls. The ATA uses wedge shaped anchoring blocks to bite into the casing wall when right hand torque is generated in the tubing string. These anchoring blocks are spring loaded so the transfer of torque to the casing is immediate. Its best applications are in deep wells, horizontal wells or heavy oil situations.

Features

- In most configurations offers greater than 95% bypass capacity
- No limits to pump size due to the ATA being centralized
- Allows $\frac{3}{4}$ " coiled tubing to bypass the anchor smoothly regardless of its orientation within the tubing
- Sand ports allow for sand evacuations from below
- Available with specialty finishes, threads and materials
- Anchoring blocks are easy to redress

ATA Specifications					
Casing		Tool Size			
Size	Weight	O.D.	I.D.	Length	Thread Connection
in mm	lbs/ft kg/m	in mm	in mm	in mm	in mm
4-1/2 114.3	9.5 - 13.5 14.1 - 20.1	4.09 103.9	2.44 62.0	21.88 555.8	2-7/8 EUE 73.0
5 127.0	11.5 - 20.3 17.1 - 30.2	4.56 115.8	2.50 63.5	21.88 555.8	2-7/8 EUE 73.0
5-1/2 139.7	14 - 20 20.8 - 29.8	5.01 127.3	2.50 63.5	21.88 555.8	2-7/8 EUE 73.0
			3.00 76.2		3-1/2 EUE 88.9
	15.5 - 23 23.1 - 34.2	4.95 125.7	2.50 63.5		2-7/8 EUE 73.0
	17 - 26 25.3 - 38.7	4.89 124.3			
5-3/4 146.1	16.5 - 24.2 24.6 - 36.0	5.20 132.0	2.50 63.5	21.88 555.8	2-7/8 EUE 2-7/8 NUE 73.0
6-5/8 168.3	20 - 32 29.8 - 47.6	6.05 153.6	2.50 63.5	21.88 555.8	2-7/8 EUE 73.0
			3.00 76.2	22.38 568.5	3-1/2 EUE 88.9
7 177.8	17 - 29 25.3 - 43.2	6.54 166.1	2.50 63.5	21.88 555.8	2-7/8 EUE 73.0
			3.00 76.2	22.38 568.5	3-1/2 EUE 88.9
			3.96 100.6	23.08 586.2	4 -1/2 EUE 114.3
	26 - 32 38.7 - 47.6	6.28 159.5	3.00 76.2	22.38 568.	3-1/2 EUE 88.9
26 - 44 38.7 - 65.5					
7-5/8 193.7	20 - 33.7 29.8 - 50.2	7.13 181.0	2.50 63.5	21.88 555.8	2-7/8 EUE 73.0
8-5/8 219.1	32 - 44 47.6 - 65.5	7.92 201.2	3.00 76.2	22.38 568.5	3-1/2 EUE 88.9
9-5/8 244.5	32.3 - 43.5 48.1 - 64.7	9.00 228.6	3.00 76.2	22.38 568.5	3-1/2 EUE 88.9
	36 - 43.5 53.6 - 64.7	8.92 226.6	3.96 100.6	22.88 581.2	4-1/2 EUE 114.3
	36 - 53.5 53.6 - 79.6				